

# **Operating instructions and installation manual**



**FOR THE WAY IT'S MADE.®**



<b>Before using the appliance</b>	<b>4</b>
<b>Safeguarding the environment</b>	<b>4</b>
<b>Precautions and general recommendations</b>	<b>5</b>
<b>Installation requirements</b>	<b>6</b>
<b>Technical specifications</b>	<b>7</b>
<b>Installation</b>	<b>7</b>
<b>Foreword</b>	<b>9</b>
<b>First use</b>	<b>10</b>
<b>Troubleshooting guide</b>	<b>12</b>
<b>After-sales service</b>	<b>13</b>

## Before using the appliance

Your new appliance is designed exclusively for domestic use.

To ensure best use of your appliance, carefully read the operating instructions which contain a description of the product and useful advice.

Keep this booklet for future consultation.

1. After unpacking the appliance, make sure that it is not damaged and that the door closes properly. Any damage must be reported to the dealer within 24 hours of delivery of the appliance.

2. Wait for at least two hours before switching the appliance on, so that the cooling circuit has time to reach full efficiency.
3. Make sure that the installation and electrical connection are carried out by a qualified engineer according to the manufacturer's instructions and the local rules in force.
4. Clean the inside of the appliance before using it.

## Safeguarding the environment

### 1. Packing

The packaging material is entirely recyclable and marked with the recycling symbol . Follow local regulations for scrapping. Keep the packaging materials (plastic bags, polystyrene parts, etc.) out of reach of children, as they are potentially dangerous.

### 2. Scrapping/Disposal

The appliance is manufactured using recyclable material.

This appliance is marked according to the European Directive 2002/96/EC, Waste Electrical and Electronic Equipment (WEEE). By ensuring this product is disposed off correctly, you will help prevent potential negative consequences for the environment and human health, which could otherwise be caused by inappropriate waste handling of this product.

The symbol  on the product, or on the documents accompanying this appliance indicates that this product should not be disposed off as household waste. Please dispose of this appliance at an Electrical & Electronic Equipment Collection point as in accordance with local environmental regulations for waste disposal.

When it is scrapped, make it unusable by cutting the power cable and removing the doors and shelves so that children cannot access the inside easily.

Scrap it according to the local rules for the disposal of waste and take it to a collection point. Do not leave it unattended even for a few days because it is a source of danger for children.

For details of your local Collection Point please contact your Local Authority.

### Information:

This appliance does not use CFC. The refrigerant system contains either R134a (HFC) or R600 (HC). Refer to the rating plate inside the appliance.

Appliances with Isobutane (R600a): isobutane is a natural gas without environmental impact, but is flammable. Therefore, make sure the refrigerant circuit pipes are not damaged.

This product may contain Fluorinated Greenhouse Gases covered by the Kyoto Protocol; the refrigerant gas is inside a hermetically sealed system.

Refrigerant gas: R134a has a Global Warming Potential of (GWP) 1300.

### Declaration of conformity

- This appliance is intended for storing food and is manufactured in conformity with European regulation (EC) No. 1935/2004.



- This product has been designed, manufactured and marketed in compliance with:
  - the safety objectives of Low Voltage Directive 2006/95/EC (replacing 73/23/EEC and subsequent amendments);
  - the protection requirements of Directive "EMC" 2004/108.

Electrical safety of the appliance can only be guaranteed if it is correctly connected to an approved earthing system.



# Precautions and general recommendations

## INSTALLATION

- The appliance must be handled and installed by two or more persons.
- Be careful not to damage the floors (e.g. parquet) when moving the appliance.
- During installation, make sure the appliance does not damage the power cable.
- Make sure the appliance is not near a heat source.
- To guarantee adequate ventilation, leave a space on both sides and above the appliance and follow the installation instructions.
- Keep the appliance ventilation openings free.
- Do not damage the appliance refrigerant circuit pipes.
- Install and level the appliance on a floor strong enough to take its weight and in a place suitable for its size and use.
- Install the appliance in a dry and well-ventilated place. The appliance is designed for use in area where the temperature comes within the following ranges, according to the climatic classification given on the rating plate. The appliance may not work properly if it is left for along period at a temperature above or below the specified range.

Climatic Class	Amb. T. (°C)	Amb. T. (°F)
SN	from 10 to 32	from 50 to 90
N	from 16 to 32	from 61 to 90
ST	from 16 to 38	from 61 to 100
T	from 16 to 43	from 61 to 110

- Make sure the voltage specified on the rating plate corresponds to that of your home.
- Do not use single/multi adapters or extension cords.
- For the water connection, use the pipe supplied with the new appliance; do not reuse that of the previous appliance.
- Power cable modification or replacement must only be carried out by qualified personnel.
- It must be possible to disconnect the appliance from the power supply by unplugging it or by means of a mains double-pole switch installed upstream of the socket.

## SAFETY

- Do not store or use petrol, flammable liquids or gas in the vicinity of this or other electrical appliances. In fact, the fumes can cause fires or explosions.
- Do not use mechanical, electric or chemical means other than those recommended by the Manufacturer to speed up the defrost process.
- Do not use or place electrical appliances inside the product if they are not of the type expressly authorised by the Manufacturer.
- This appliance is not intended for use by persons (including children) with reduced physical, sensory or mental capabilities, or lack of experience and knowledge, unless they have been given supervision or instruction concerning use of the appliance by a person responsible for their safety.
- To avoid the risk of children becoming trapped and suffocating, do not allow them to play or hide inside the appliance.
- Do not eat ice cubes or ice lollies immediately after taking them out of the freezer since they may cause cold burns.

## USE

- Before any maintenance or cleaning, unplug the plug from the power socket or switch off the electrical power.
- Appliances must be connected to a water supply that only delivers drinking water (with mains water pressure of between 1.7 and 8.1 bar).

**The Manufacturer declines any liability if the above advice and precautions are not respected.**

# Installation requirements

## Location zone conditions

The ice maker machines are designed to operate at room temperature between 5°C (41°F) and 43°C (109.40°F).

## Housing dimensions

To install the ice maker in the correct way, it will be necessary that the hole located for such effect in the piece of furniture has the dimensions established in the drawing (560x440x560 mm). The drainage must be in the position indicated in the drawing. In the left part of the housing and below the inferior level of the machine. In this way the flexible pipes have the enough path to allow the extraction of the machine.

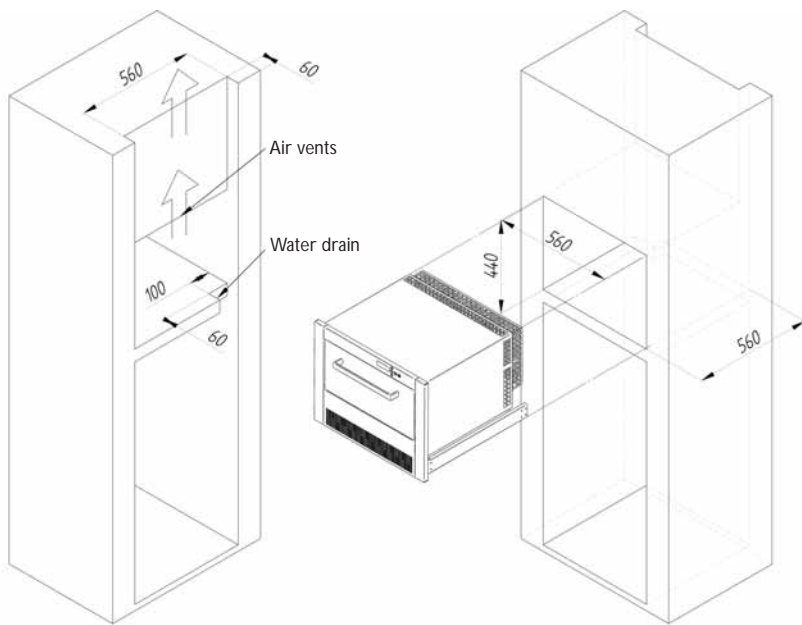

## IMPORTANT

It must be taken into account that an exit must be left for the air that the machines takes through the front louver. It can be a back hole (with an outdoor exit) or a louver on the machine. The water connection, drainage and electrical steps of the equipment are also necessary (see the figure).

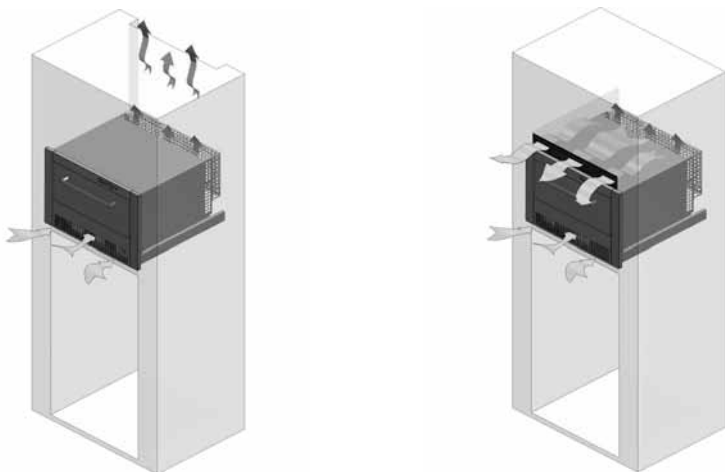

## Technical specifications

- Sizes: External: 596x455x22  
Cabinet hole size: 560x440x560
- Mounting on sliding rails.
- Production:  
Rated production: 10 Kg/24h (Ambient temperature 20°C / Water temperature 15°C).
  - 12 cubes/cycle
  - ice cube weight 22 g
  - Ice tank: 8 Kg
- Power supply connection:
  - Power supply: 220 V / 50 Hz.
  - Power: 250 W
  - Intensity: 1.8 A
- Water connection:
  - Male thread tap socket  $\frac{3}{4}$ " BSP
  - Consumption: 2.4 l/h
  - Maximum instantaneous capacity: 1 l/min
  - Pressure: 1-5 bar
- Cooling:
  - Refrigerant: R134A
  - Air condensation. Front input. Back output.

## Installation

### Anchoring of the machine

Follow the following steps:

1. Screw the guides in the hole of the piece of furniture to have them horizontally and set back 5 mm as it is indicated on the figure.

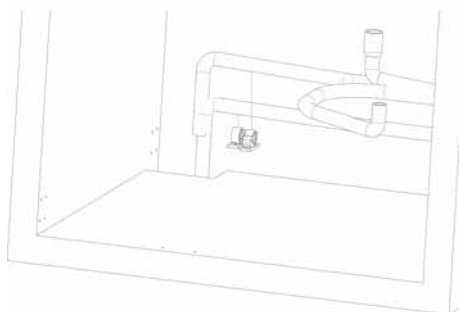
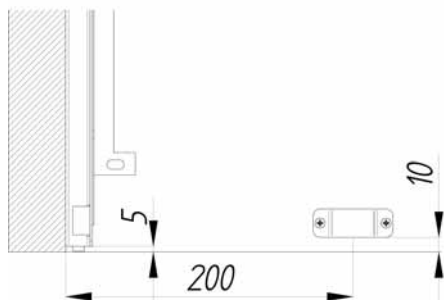
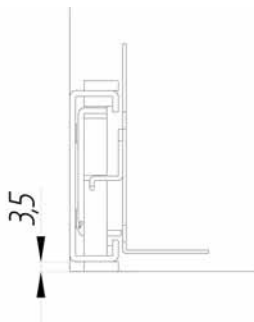
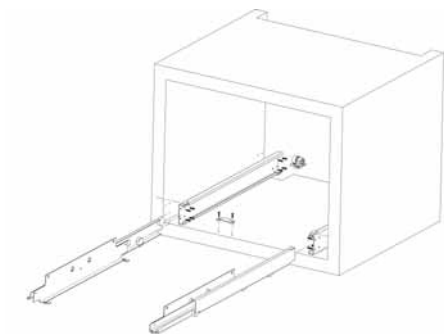

2. Screw the fastening bridge of the machine in the position of the drawing.
3. Screw the fastening flanges of the drainage hoses.
4. Place the machine on the support angles of the guides. Adjust the width before fastening the screws checking that it slides softly along the path.

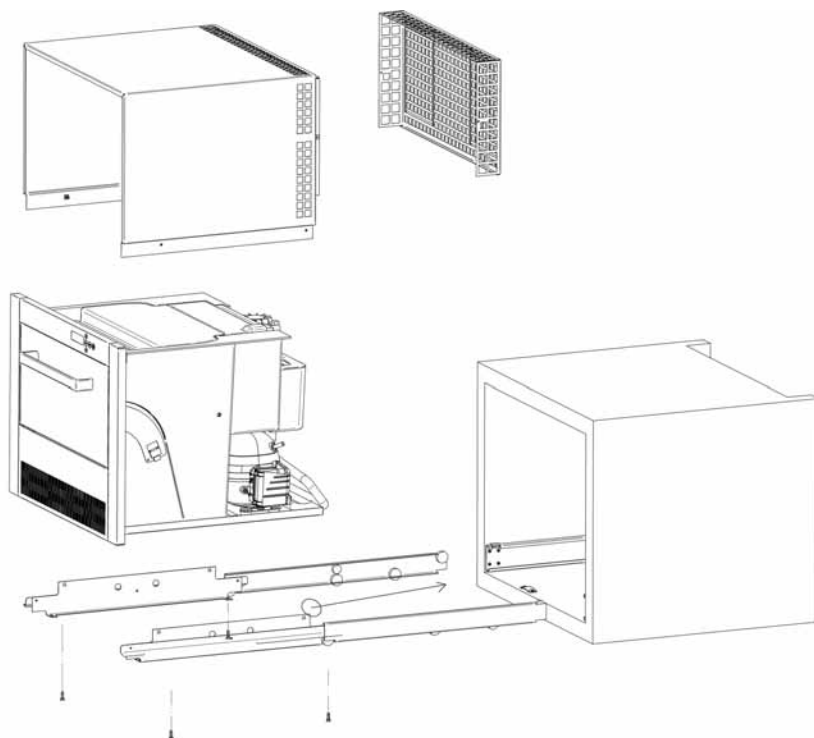

### Connections to the Water Network

Use the flexible pipe with the two filter joints supplied with the machine. Pressure should be between 1 and 5 Bar.

If pressures overpass such values, install the necessary corrective devices.

Leave free the needed length to extract the machine up to the end of the guides.

The rest can be flanged and gathered at a side to avoid that when storing the machine it can touch the water pump and stop it or make noise.

### Connection to drainage

The drainage must be in the position established in the drawing. In the left part of the housing and below the inferior level of the machine. In this way the flexible pipes have the enough path to allow the extraction of the machine.

It is convenient that the drainage pipe has an entry with an interior diameter of 50 mm to introduce the two drainage hoses of the machine.

Fix the pipes with the flanges that were provided. Thus, we ensure that when taking out and storing the machine, the pipes do not come out.



# Foreword

- The appliance requires connection to the water supply for filling with drinkable water, and a drainage outlet for any residual cycle water.
- The appliance has a cyclical operation: the production cycle continues until the container is full; a thermostat below the ice output automatically stops the appliance when the tank is full.
- When the quantity of ice falls below a certain level, due to use or melting, the same thermostat will reactivate the appliance. Any residual water due to melting is directed outside the appliance through the discharge pipe. The appliance can produce approximately 12 cubes every 40 minutes.

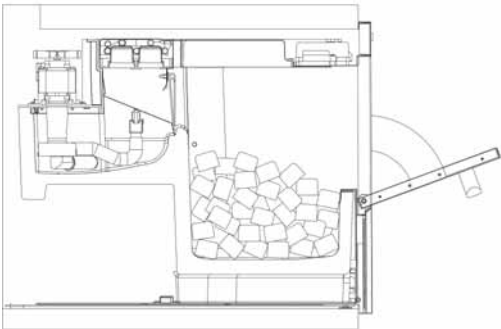
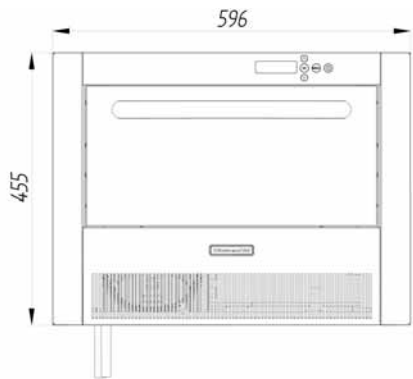

## CONTROL PANEL DESCRIPTION

1. Display
2. Confirmation key
3. Menu
4. Program selection arrows
5. Appliance ON/OFF key

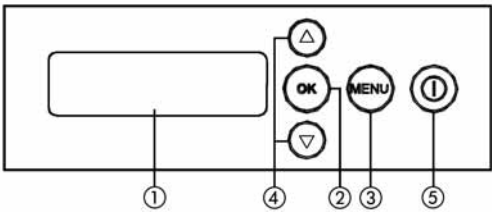

## First use

### Settings

#### Warning:

before opening the settings menu ensure that the appliance is off.

The following parameters can be set

TIME



PROGRAMMING OF THE APPLIANCE

NUMBER OF ICE CUBES

ICE CUBE SIZE

LANGUAGE

### Setting the time

Set the desired time using the program selection arrow   (the hours will flash first, followed by the minutes) and confirm the selection at each stage using the OK key.

### Programming the appliance

When the appliance is switched on, it will automatically be set to the "Program disabled" option. To begin the cycle start and end setting operation, select "program enabled" and press OK to confirm.

The cycle start and end times are set in the same way as the clock. The display can be used to enter the time for appliance startup in the desired hh:mm format (the appliance will keep the last settings in the memory). Press OK to return to the main menu. At the set start time the appliance will switch on and operate until the set stop time.

#### IMPORTANT NOTE:

If the set cycle start and end times are before the current time shown on the clock, the settings will be kept for the following day.

If the start time is before the time currently set on the clock, pressing OK to confirm will automatically activate the appliance, which will continue operation until the set end time is reached.

### Number of ice cubes

The appliance has 3 separate production modes:

- CONTINUOUS: the appliance will produce ice cubes until switched off or until the ice cube container is full.
- 24: maximum allowed number of ice cubes, after which the appliance will be switched off.
- 48: maximum allowed number of ice cubes, after which the appliance will be switched off.

### Ice cube size

This option can be selected to increase or decrease the size of the ice cubes based on personal needs. To increase or decrease size use the arrows.

### Language

To change the language select Menu - Language and then the desired language. Press OK to confirm.

## **Startup**

The appliance is configured at the factory with preset values.

Warning: In case of power cut, all values will be lost and must be reset.

Before switching the appliance off, a thorough cleaning is necessary, following the instructions of the "Maintenance and cleaning" section.

- Insert the plug in the electric socket.
- Press the ON key for a few seconds.
- Two minutes after switching the appliance on, the water circulation pump and the cooling system will be activated.

## **Maintenance and Cleaning**

- Always disconnect the appliance from the electric power supply before performing any maintenance or cleaning operations.
- Regularly clean the appliance using a cloth and a solution of warm water, with some soft detergent, suitable for cleaning the inside of the unit.
- Never use abrasive detergents.
- Do not use steam cleaners.
- The panel keys and display must not be cleaned using alcohol based substances or similar. Only use a dry cloth.

## **Cleaning the internal tank**

- Disconnect the appliance from the electric power supply and remove any left over ice cubes from the tank.
- Clean using a damp cloth and a neutral detergent.
- Remove all limescale traces applying a specific limescale product. Give the product time to act and then remove with a dry cloth.

# Troubleshooting guide

If the appliance does not operate correctly, or does not operate at all, before contacting customer care refer to the following alarm table:

Alarm	Probable cause	Verification
Full tank Bin Machine is stopped	Thermostat failure	In the storage bin the ice cubes do not touch the thermostat rod
Cycle probe. Machine is stopped	Damaged cycle probe	Room temperature information menu *****
High temperature Machine is stopped	Lack of ventilation	Objects that block the machine air inlet
		Dirty ventilation filter
		Dirty condenser
Short time Machine is stopped	Ice cake formation in the machine	Check condensation and water inlet pressure
	The showers do not water	The pump does not work
		The impulse tube is loose
Long time Machine is stopped	The compressor or the fan isn't working	Output 1 information menu, signal during manufacturing process.
	Lack of ventilation	Low or no passage of recommended air outlets

# After-sales service

## Before contacting the After-sales Service:

1. Ensure that you are unable to resolve the fault.
2. Switch the appliance on again to see if the problem has been solved. If it has not, disconnect the appliance from the power supply and wait for about an hour before switching on again.
3. If the problem persists contact After-sales Service.

## Specify:

- the type of fault,
- the model,
- the Service number (the number after the word SERVICE on the rating plate on the back the appliance),
- your full address,
- your telephone number and area code.

**SERVICE** 0000 000 00000







